



VALVE CLEARANCES - ADJUST



CAUTION: To prevent possibility of damage to cam follower seatings, it is essential that ball ends of tappet adjusting screws are seated in recess in push rods and that ball end of each push rod is correctly located in cam follower slide.

1. Rotate crankshaft by means of crankshaft pulley bolt in a clockwise direction until number 8 valve (counting from front of engine) is fully open.

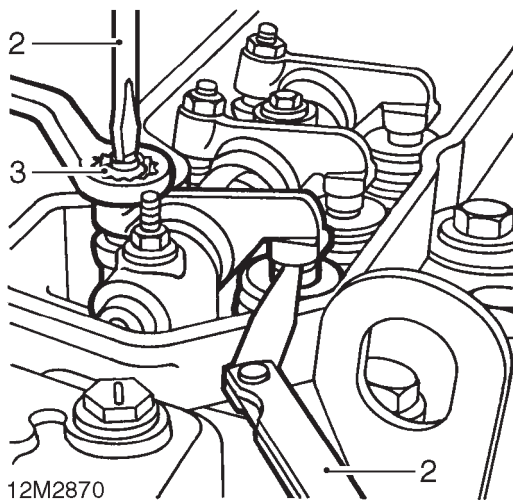

2. Using feeler gauges and a screwdriver, adjust clearance of number 1 valve.
Valve clearance - all valves = 0.20 mm
3. Tighten tappet adjusting screw locknut when clearance is correct.
4. Adjust the remaining valve clearances in the following sequence:
Adjust number 3 clearance with number 6 valve fully open
Adjust number 5 clearance with number 4 valve fully open
Adjust number 2 clearance with number 7 valve fully open
Adjust number 8 clearance with number 1 valve fully open
Adjust number 6 clearance with number 3 valve fully open
Adjust number 4 clearance with number 5 valve fully open
Adjust number 7 clearance with number 2 valve fully open
5. Upon completion, re-check all clearances and adjust as necessary.