

Part. No:

Type:

**Defender 90 Hard Top and County Station Wagon**

- RBL033 4SSS** Single Hoop Roll Bar for vehicles **with Headlining** - without diagonal bolt&weld
- RBL033 5SSS** Single Hoop Roll Bar for vehicles **with Headlining**- with diagonal bolt&weld
- RBL115 4SSS** Single Hoop Roll Bar for vehicles **without Headlining** - without diagonal bolt&weld
- RBL115 5SSS** Single Hoop Roll Bar for vehicles **without Headlining**- with diagonal bolt&weld
- RBL033/115-FK-90** Fitting Kit for Defender 90

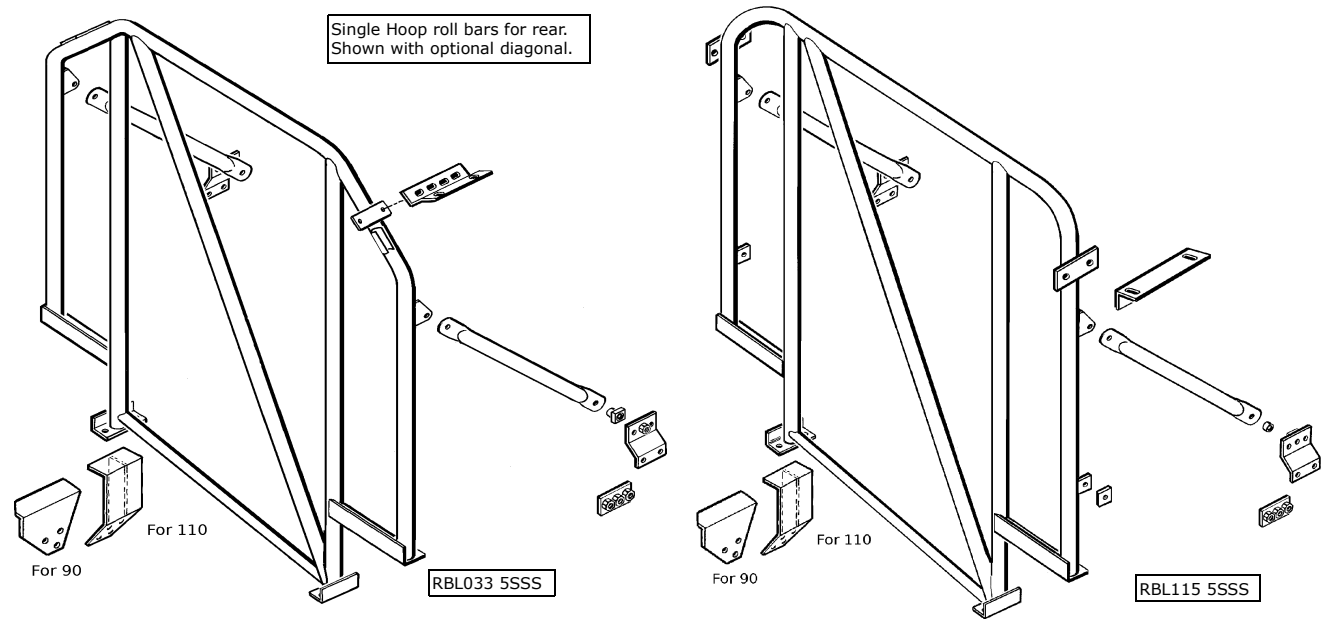

- RBL092 6SSS** Internal single hoop, ext. front legs, long b/stays to rear chassis- fits **without** rear headlining. Camel Trophy specification roll cage bolt&weld
- RBL142 6SSS** Internal single hoop, ext. front legs, short b/stays fits **with** full headlining and rear seats. Best for CSW bolt&weld

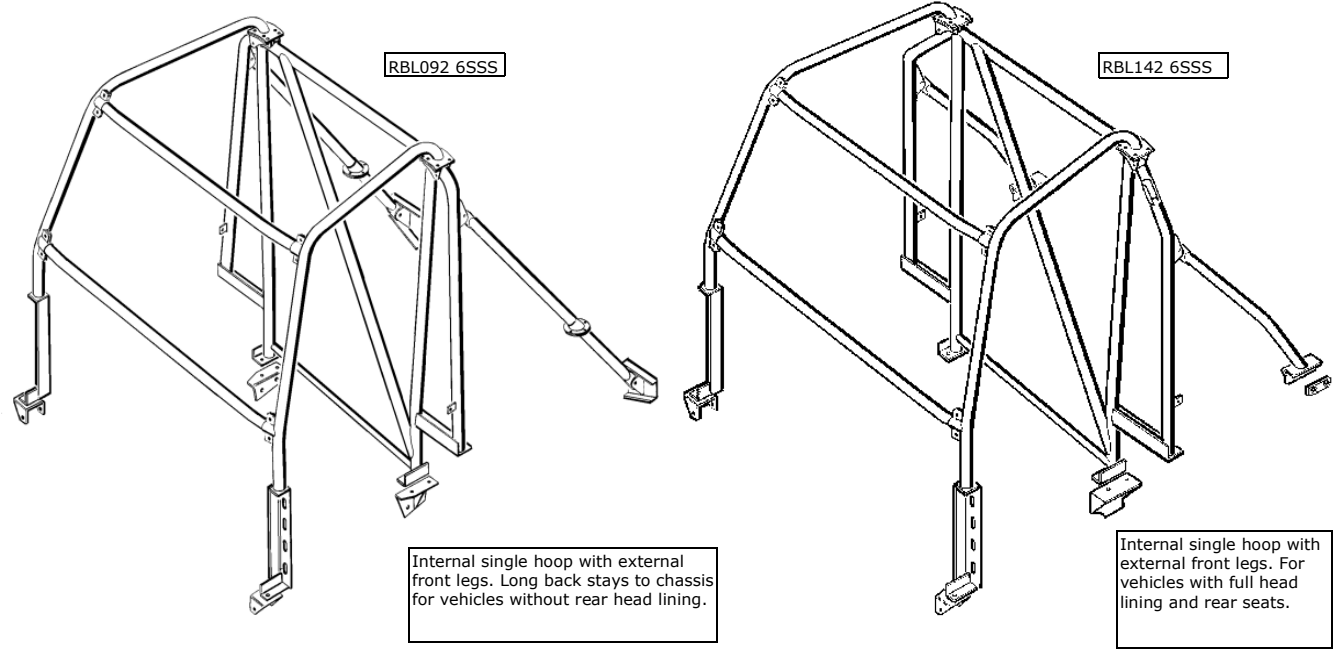

Specifications are subject to change without notice.  
For price information see Price List.

**Part. No:**

**Type:**

**RBL138 3SSS** External front cage -fits **H/Top** and **CSW (Defender 90&110)**

bolt-in

**RBL138 7SSS** External front and internal rear cage -fits **H/Top** and **CSW (Defender 90&110)**

bolt-in

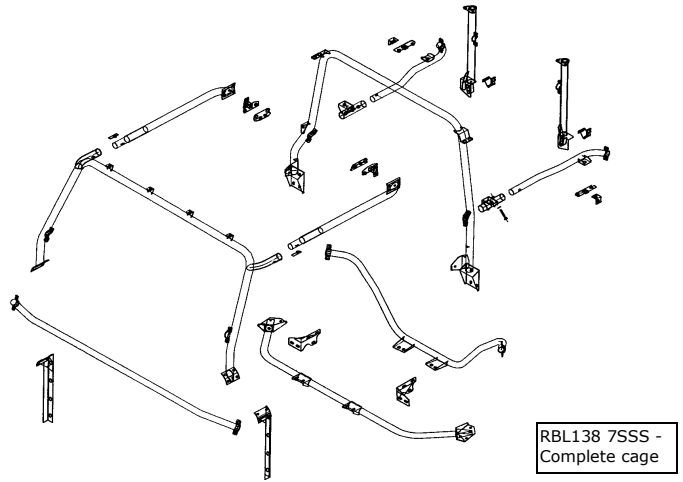
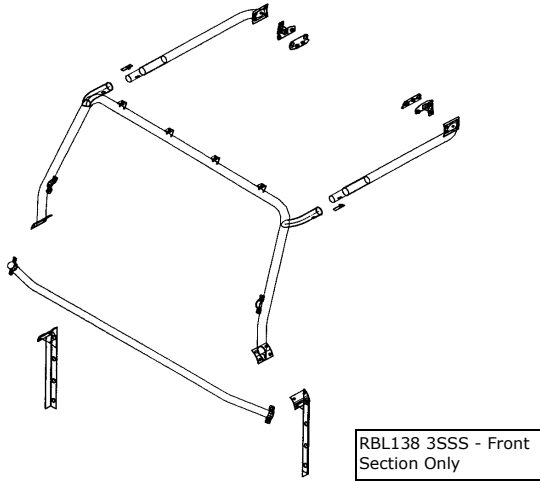

**RBL181 7SSS** Internal 'B' & 'D' post hoop, ext. front legs-full cage-fits **CSW**  
*Similar to L142, with short back stays-additional D post hoop and cant rails*  
*Ideally suited for vehicle with full length headlining*

bolt&weld

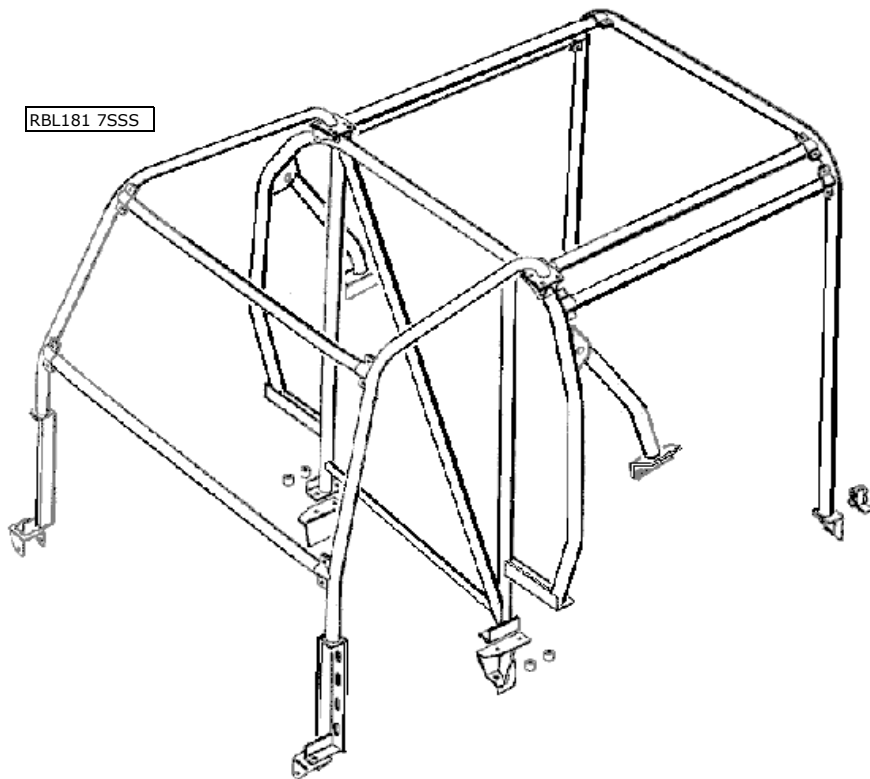

**Part. No:**  
**RBL108 7SSN** Full External Roll Cage - fits H/Top, CSW & Soft-Top **with bulkhead**

**Type:**  
 bolt-in

**RBL213 7SSS** Full External Roll Cage for **non-bulkhead** Defender 90

bolt-in

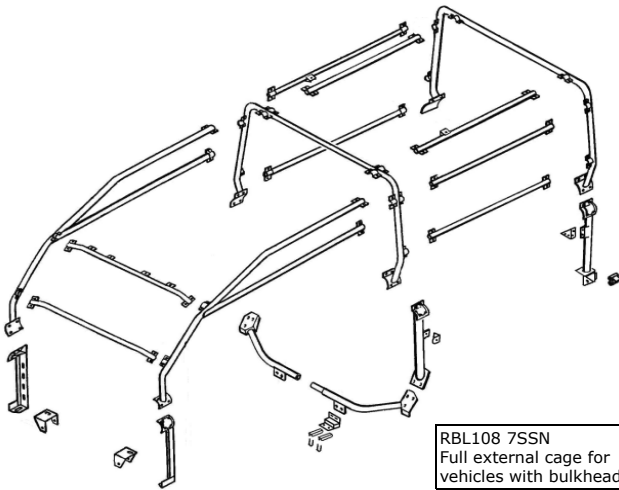

RBL108 7SSN  
 Full external cage for vehicles with bulkhead

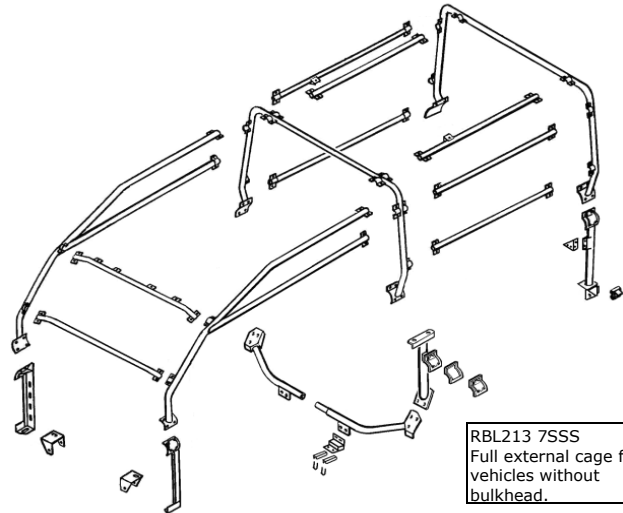

RBL213 7SSS  
 Full external cage for vehicles without bulkhead.

**Defender 90 Truck Cab - Roll Cages**

**RBL111 5SNS** Rear Military Style Hoop 2" **with** diagonal. Mounts through cappings into corner brackets. Backstays go to waist rail cappings.

bolt-in

**RBL111 4SNS** Rear Military Style Hoop 2" **without** diagonal. Mounts through cappings into corner brackets. Backstays go to waist rail cappings.

bolt-in

Drawing shows RBL111 5SNS which includes the diagonal. RBL111 4SNS is identical but minus the diagonal.

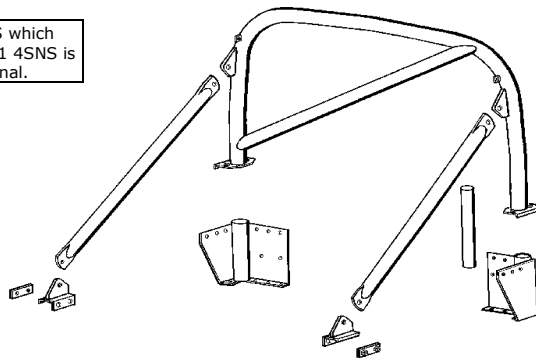

**RBL153 6SSS** Truck Cab External Cage 2" tube waist rail backstays

bolt&weld

**RBL153-FK-90** Defender 90 Fitting Kit for above cage

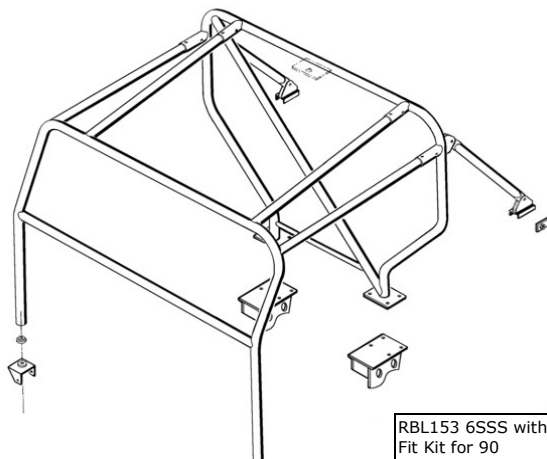

RBL153 6SSS with Fit Kit for 90

**Part. No:**

**Defender 90 Soft Top - Roll Cages**

**Type:**

- |                    |   |         |
|--------------------|---|---------|
| <b>RBL122 5SNS</b> | Rear Military Style Hoop 2" <b>with</b> diagonal. Mounts through cappings into corner brackets. Backstays go to waist rail cappings. Front seatbelt shoulder anchor points    | bolt-in |
| <b>RBL122 4SNS</b> | Rear Military Style Hoop 2" <b>without</b> diagonal. Mounts through cappings into corner brackets. Backstays go to waist rail cappings. Front seatbelt shoulder anchor points | bolt-in |

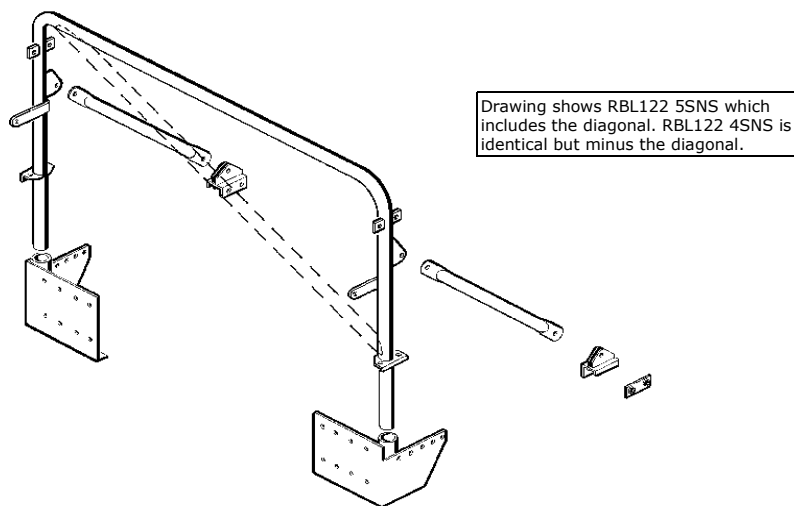

- |                    |  |         |
|--------------------|--|---------|
| <b>RBL169 7SSS</b> | Full External Rear Cage to replace original hoodsticks 45mm tube diameter, single diagonal, backstays to waist rail includes front seat belt anchor points (not pictured). | bolt-in |
|--------------------|--|---------|

- |                    |  |         |
|--------------------|--|---------|
| <b>RBL188 6SSS</b> | External/Internal roll cage, utilises existing hood which <b>will need modification</b> . Front legs are NAS style | bolt-in |
|--------------------|--|---------|

